



G-4610 Beecher Road Flint, MI 48532
 Phone (810) 732-7870 Fax (810) 732-9773
www.ocdcwws.com

RESIDENTIAL SOIL EROSION & SEDIMENTATION CONTROL PERMIT APPLICATION

1. LANDOWNER

NAME:				
ADDRESS:			E-MAIL:	
CITY:	STATE:	ZIP:	PHONE:	

2. LOCATION

SECTION	<input type="checkbox"/> CITY <input type="checkbox"/> TOWNSHIP <input type="checkbox"/> VILLAGE	PROPERTY TAX ID #
SUBDIVISION:	LOT #	STREET ADDRESS:

3. PROPOSED EARTH CHANGE

Describe Project	Size of Earth Change (Acres, Linear feet or square feet)
Name of and distance to nearest Lake, Stream, or Drain	Date Project is to start
	Date Project is to be complete

4. PARTIES RESPONSIBLE FOR EARTH CHANGE

Name of <i>Individual</i> "On Site" Responsible for Earth Change (if not provided in box 1 above)				
Company Name			E-Mail Address	
Address	City	State	Zip	Phone

5. NOTICE TO APPLICANT

I understand that if a soil erosion and sedimentation control permit OR a waiver of a soil erosion and sedimentation control permit is issued, the above-mentioned property is not exempt from enforcement procedures under Part 91, of Act No. 451 of the Public Acts of 1994, as amended, being MCL § 324.32501 *et. seq.*

I hereby acknowledge that if a soil erosion and sedimentation control permit OR a waiver of a soil erosion and sedimentation control permit is issued, I hereby voluntarily grant the employees of the Genesee County Drain Commissioner's Office, Division of Water and Waste Services, or their designated agents permission to enter onto my property as set forth herein to ensure that the project conforms to the reason stated above as to why the proposed project qualifies for a soil erosion and sedimentation permit waiver. I further understand that if I

revoke my consent for the employees of the Genesee County Drain Commissioner's Office, Division of Water and Waste Services, or their designated agents to enter onto the property set forth herein, the permit waiver is automatically revoked, I will need to resubmit a new soil erosion and sedimentation permit application or waiver certification, and I must cease all earth moving activities on the property.

I further understand that if I continue to perform earth moving activities on the property after revoking my consent for the employees of the Genesee County Drain Commissioner's Office, Division of Water and Waste Services, or their designated agents to enter onto the property set forth herein, I may be subject to one or more of the enforcement procedures set forth in Part 91 of Act No. 451 of the Public Acts of 1994, as amended, and the administrative rules promulgated thereunder, including, but not limited to, being issued a civil infraction citation, having an injunction issued to prevent any further earth moving activities on the aforementioned property, the right of the Genesee County Drain Commissioner's Office, Division of Water and Waste Services or its agents to enter onto my property to install soil erosion and sedimentation control procedures and lien the property for all costs associated with installing the soil erosion and sedimentation control procedures, and/or the forfeiture of any security submitted in the amount required to bring the property into compliance with Part 91 of Act No. 451 of the Public Acts of 1994, as amended.

I hereby acknowledge that the information contained herein is truthful and accurate to the best of my knowledge. I understand that if I knowingly make any false statement in this application it may result in a civil fine of not more than \$10,000.00 per day for each violation.

I (we) affirm that the above information is accurate and that I (we) will conduct the above-described earth change in accordance with Part 91, Soil Erosion and Sedimentation Control, of the Natural Resource and Environmental Protection Act, 1994 PA 451, as amended, applicable local ordinances, and the documents accompanying this application.		
Landowner's Signature	Print Name	Date
Designated Agent's Signature*	Print Name	Date

- * Designated agent must have a written statement from landowner authorizing him/her to secure a permit in the landowner's name.

OFFICE USE ONLY

**Genesee County Drain Commissioner Division of Water and Waste Services
RESIDENTIAL Minimum Soil Erosion and Sedimentation Control Plan Submittal Requirements**

All SESC applications submitted to this office shall at a minimum be accompanied by the following information.

1. Soil Erosion and Sedimentation Control application review fee. Fee schedule is listed below. Checks shall be payable to the Genesee County Drain Commissioner's Office.

Application Review Fee
Single Family Residential: \$ 35.00

2. Legal description, tax I.D. number and/or survey of site.
3. A SESC site plan (scale of not more than 1"=200' on 24"x36" sheets) of the property with the items below clearly labeled :(Residential can be submitted on letter or legal paper)
 - A. Name and address of Applicant. Name and address of landowner.
 - B. Project Name, location, proximity to waters of the State (lake, stream, drain, wetlands) and (the 100 year floodplain contour for those waters for commercial applications only).
 - C. Location map, NORTH arrow and drawing scale.
 - D. Limits of earth change delineated and clearly labeled.
 - E. Existing and proposed contours. If unchanged so state.
 - F. Existing and proposed on-site and off-site (within drainage area of earth change) drainage and dewatering facilities including temporary dewatering shall be clearly labeled and identified.
 - G. Existing on-site vegetation (type and location).
 - H. Soil stock pile locations.
 - I. Description of installation and location of all temporary and permanent erosion control measures, with measures clearly drafted and labeled with the (Michigan Unified Keying System and GCDC-WWS Specifications for commercial applications only).
 - J. A program proposal for the continued maintenance of all permanent soil erosion and sediment control measures that remain after project completion.

K. Person responsible for continued maintenance once permit is closed

Name: _____
Address: _____
Phone #: _____
Email address: _____

4. A topographic map with the affected area clearly labeled.
5. Existing soils information, with project area clearly labeled. (Soils Map)
6. A completed Soil Erosion and Sedimentation Control application.
7. A completed construction and maintenance schedule including a plan for permanent stabilization.
8. A copy of any submitted MDEQ permit applications (as applicable) required for completing earthwork within the boundaries of waters of the state.
9. A copy of sedimentation basin capacity calculation for sites that require sedimentation basins. (This may not be required for Residential Properties)

I hereby certify that the above information has been provided with the submitted plans.

Name of Party Preparing Checklist: _____

Signature: _____

Date: _____

SESC CONSTRUCTION AND MAINTENANCE SCHEDULE

Project Name: _____
 Anticipated Start Date: _____
 Anticipated End Date: _____

Construction Schedule

Construction Sequence	Jan	Feb	Mar	Apr	May	Jun	Jul	Aug	Sep	Oct	Nov	Dec	Notes
Temporary SESC Measures													
Building Demolition													
Strip and Stockpile													
Rough Grading													
Underground Utilities													
Road Installation													
Building Construction													
Permanent SESC Measures													
Final Grade													
Landscaping													

Maintenance Schedule

Maintenance Sequence	Jan	Feb	Mar	Apr	May	Jun	Jul	Aug	Sep	Oct	Nov	Dec	Notes
Street Sweeping													
Silt Fencing													
Maintain Buffer Strips													
Inlet Structures													
Seeding and Mulch													
Sediment Basins													
Rip-Rap													
Remove Temporary Measures													

Seeding and Planting Schedule

Temporary: (Refer to Tables 4 & 6 in MDEQ "Guidelines for Vegetative Erosion control" included with this packet)

Area on Plan	Mix #	Common Name	Natural Drainage Class Suitability	Suitable Uses	Rate lb/acre

Permanent: (Refer to Tables 4 & 6 in MDEQ "Guidelines for Vegetative Erosion control" included with this packet)

Area on Plan	Mix #	Common Name	Natural Drainage Class Suitability	Suitable Uses	Rate lb/acre

Trees and Shrubs: (Refer to Table 7 in MDEQ "Guidelines for Vegetative Erosion control" included with this packet)

Area on Plan	Quantity	Common Name	Scientific Name	Drainage Class	Notes

EXAMPLE SINGLE FAMILY HOME SITE PLAN MINIMUM GUIDE FOR RESIDENTIAL SESC APPLICATION

HOUSE PLOT PLAN FOR:
JOE SMITH
1111 MAIN STREET
FLINT, MI 48503

LOT 74 OF "MORIDAN ACRES" AS
RECORDED IN LIBER 55, PAGES
222-225

**NOTE: THIS EXACT
EXAMPLE PAGE IS NOT
TO BE INCLUDED IN
THE PERMIT.**



1" = 30'

INSTALL SILT FENCE
PER GENESEE COUNTY
SPECIFICATIONS*

OPTIONAL 35'
MINIMUM VEGETATIVE
BUFFER STRIP LIMITS
TO BE APPROVED BY
GCDC-WWS

LOCATION MAP

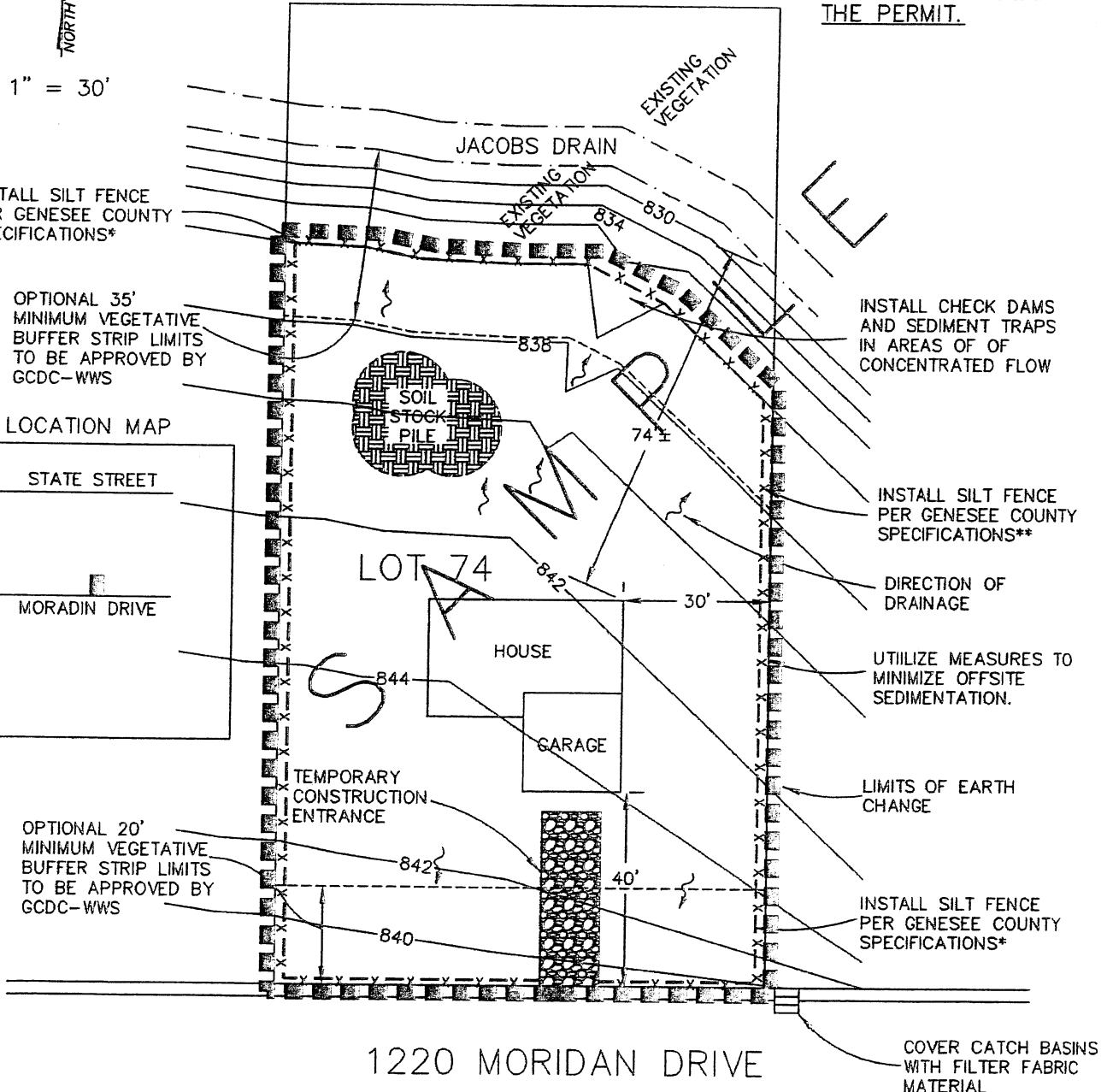
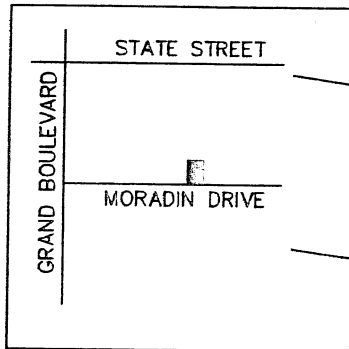

INSTALL CHECK DAMS
AND SEDIMENT TRAPS
IN AREAS OF OF
CONCENTRATED FLOW

INSTALL SILT FENCE
PER GENESEE COUNTY
SPECIFICATIONS**

DIRECTION OF
DRAINAGE

UTILIZE MEASURES TO
MINIMIZE OFFSITE
SEDIMENTATION.

LIMITS OF EARTH
CHANGE

INSTALL SILT FENCE
PER GENESEE COUNTY
SPECIFICATIONS*

COVER CATCH BASINS
WITH FILTER FABRIC
MATERIAL

1220 MORIDAN DRIVE

* SILT FENCE IS NOT NECESSARY SO LONG AS A MINIMUM THICK 20' VEGETATIVE BUFFER STRIP IS MAINTAINED DURING CONSTRUCTION.

** SILT FENCE IS NOT NECESSARY SO LONG AS A MINIMUM THICK 35' VEGETATIVE BUFFER STRIP IS MAINTAINED ALONG ALL WATERS OF THE STATE DURING CONSTRUCTION.

NOTE: THE WIDTH OF THE VEGETATIVE BUFFER STRIPS WILL BE MODIFIED PER ON-SITE CONDITIONS AND BE APPROVED BY GCDC-WWS.